

REV	DATE	COMMENTS
0	03/30/11	RELEASED FOR PRODUCTION

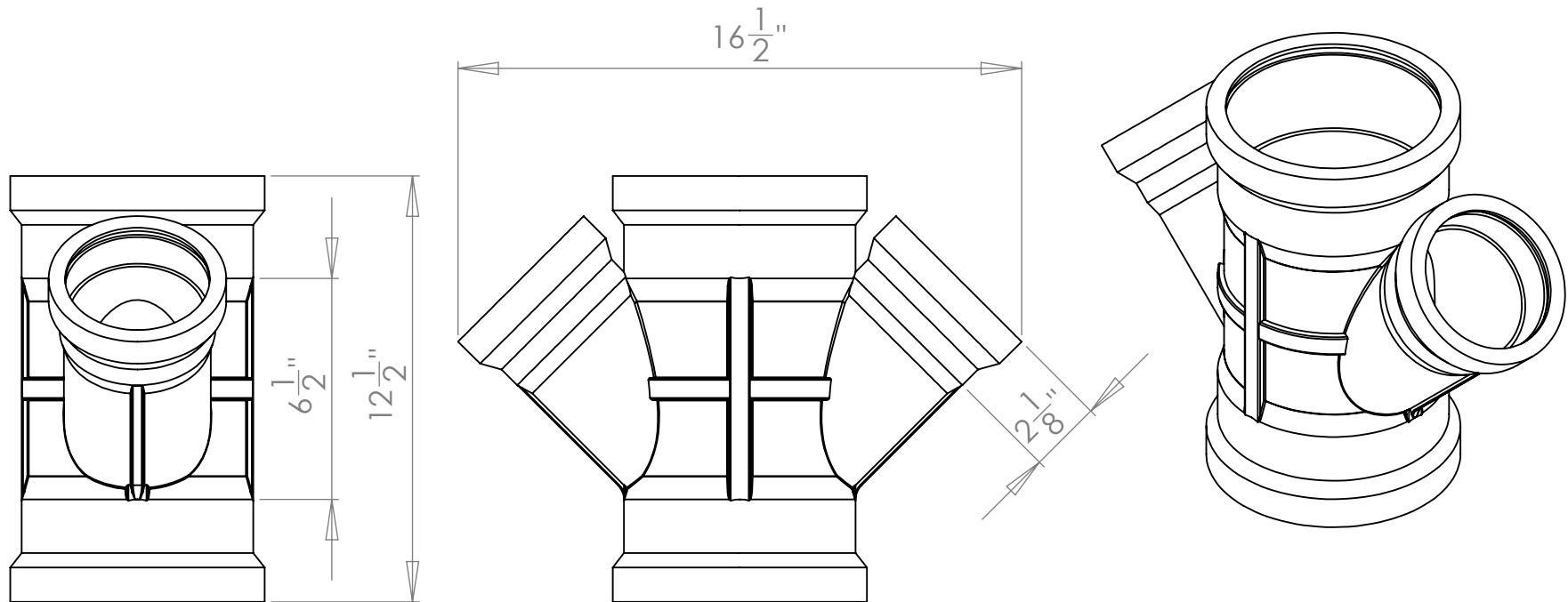

**PROPRIETARY AND CONFIDENTIAL**  
 THE INFORMATION CONTAINED IN THIS  
 DRAWING IS THE SOLE PROPERTY OF  
 GALAXY PLASTICS LTD. ANY  
 REPRODUCTION IN PART OR AS A WHOLE  
 WITHOUT THE WRITTEN PERMISSION OF  
 GALAXY PLASTICS LTD IS  
 PROHIBITED.



UNLESS OTHERWISE SPECIFIED:		NAME	DATE
DIMENSIONS ARE IN INCHES TOLERANCES: FRACTIONAL $\pm 1/64$ ANGULAR: MACH $\pm$ BEND $\pm$ TWO PLACE DECIMAL $\pm 0.01$ THREE PLACE DECIMAL $\pm 0.001$	MATERIAL	PVC	
	FINISH	N/A	
	DO NOT SCALE DRAWING		
INTERPRET GEOMETRIC TOLERANCING PER:		Q.A.	J. ANDERSON
DRAWN		B.DAVIDSON	03/30/11
CHECKED		N. KONDOLAY	03/30/11
ENG APPR.		E. TERPOCKI	
MFG APPR.		G. OLSON	
COMMENTS:			

GALAXY PLASTICS			
TITLE: 6x6x4x4 SEWER DOUBLE WYE GxGxGxG			
SIZE	DWG. NO.	REV	
<b>A</b>	111 /0604D	0	
SCALE: 1:5	WEIGHT:	SHEET 1 OF 1	